

## 1. How to allow Damas in EDGE browser

This document serves as manual how to configure the MS EDGE web browser to correctly open the EMS Damas web page.

Note: the Damas runs only with IE8 compatibility mode switch on, from that reason it is not possible to run Damas on Windows 11, which does not allow to set compatibility mode in MS Edge to IE8.

### 1.1 Prerequisites:

The following prerequisites needs to be fulfilled

- Windows 10 or older
- Edge browse (ver. 102.0.1245.33)
- Internet Explorer 11 with compatibility mode set (a native part of Windows 10)

#### 1.1.1 How to set compatibility mode in IE



The screenshot shows the Microsoft Edge browser interface. The address bar displays the URL `https://damas-test.ems.rs/Cfrmset.`. The page content includes the EMS logo and text: "Welcome on the EMS Web Site", "THE COMMUNICATION KIOSK", "Logged user: Unicorn Unicorn (EMS Managers)", "Emergency Contacts", and a list of auction notices. A red box highlights the "Settings" icon in the top right corner of the browser window, with an arrow pointing to it. The text "Settings Compatibility mode" is overlaid on the red box.



The screenshot shows the 'Compatibility View Settings' dialog box in Microsoft Edge. The dialog has a title bar with 'Compatibility View Settings' and a close button. Below the title bar is a section 'Change Compatibility View Settings' with an icon of a globe. There is an 'Add this website:' field with an 'Add' button. Below that is a list titled 'Websites you've added to Compatibility View:' with a 'Remove' button. The list contains the following entries: 192.168.146.91, 192.168.146.93, 192.168.70.11, 192.168.70.13, 62.209.222.16, **ems.rs** (highlighted in blue with a red arrow pointing to it), mms-ost.al, seecao.com, and transelectrica.ro. Below the list are two checked options: 'Display intranet sites in Compatibility View' and 'Use Microsoft compatibility lists'. A link for 'Internet Explorer privacy statement' is also present. A 'Close' button is at the bottom right of the dialog. In the background, a web page is visible with a red header 'Emergency Contacts' and a list of emergency contact information for various border directions (SERBIA\_CROATIA, SERBIA\_MONTENE, SERBIA\_BULGARIA, SERBIA\_MACEDONIA) with timestamps like '6.2022 14:02:33'.

## 1.2 Step by step solution

### 1.2.1 Allow IE mode in MS Edge

- This option is set in Edge -> Settings -> Default browser

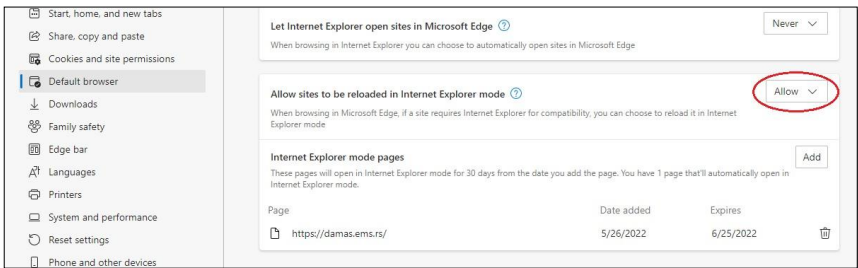
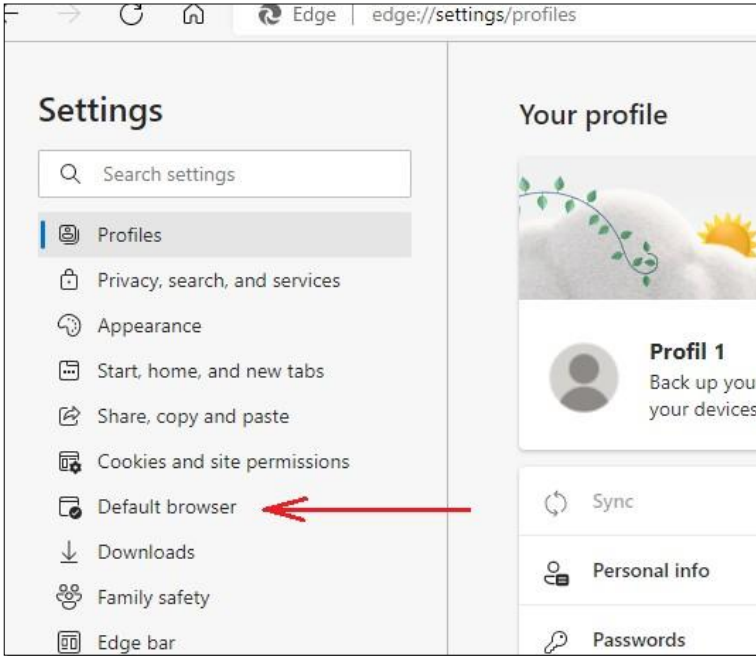

### 1.2.2 Add Internet Explorer mode button to toolbar (optional)

- This icon allows more comfortable management of IE mode  
This option is set in Settings -> Appearance

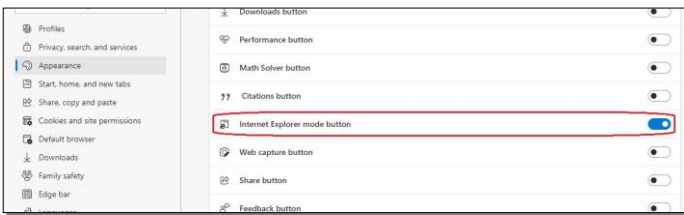
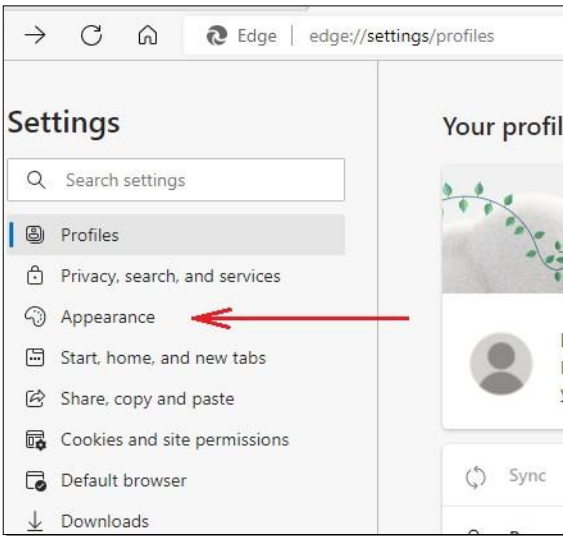



- New Icon is now shown:

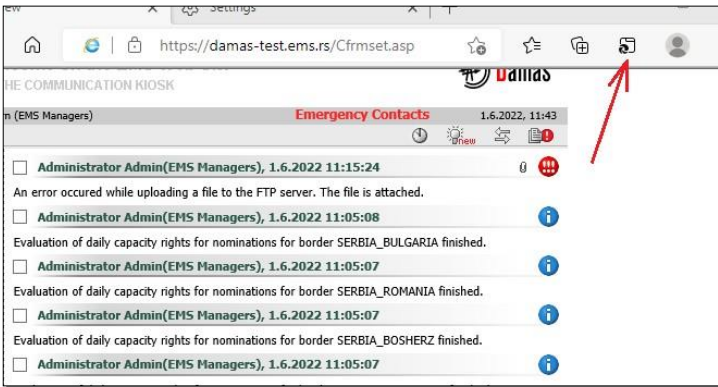

### 1.2.3 Add a selected website to Internet explorer mode pages

- It is in same settings like first step

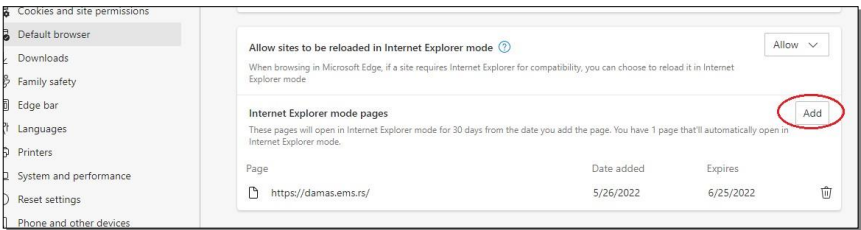

- Alternately it may be added by IE mode icon in Toolbar (form las step)
- Then Damas Serbia is running in Edge in correct mode

